

## The Electric Spindles for Woodworking

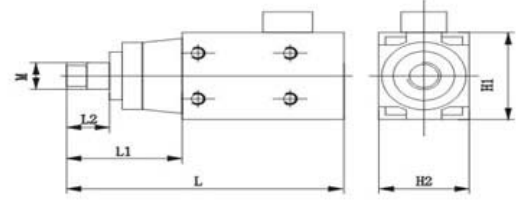

Spindle type	Speed(r/min)	KW	V	A	HZ	H1	H2	M	L	L1	L2	Bearings type
ADM40-12Z/0.12	12000	0.12	220	0.5	200	74	80	M19×1	200	64	27	1×6004VVC3/P5
												1×6002VVC3/P5
ADM40-12Z/0.35	12000	0.35	220	2	200	74	80	--	212	69	15	1×6004VVC3/P5
												1×6002VVC3/P5
ADM40-15Z/0.37	15000	0.37	220	1.6	250	74	80	M18×1.5	223	72	28	1×6004VVC3/P5
												1×6002VVC3/P5
ADX40-15Z/0.5	15000	0.5	220	1.7	250	74	80	M16×1.5	210	56	27	1×6004VVC3/P5
												1×6002VVC3/P5
ADM40-20Z/0.7	20000	0.7	220	2.3	333	74	80	M14×0.75	204	62	27	1×6003VVC3/P5
												1×6002VVC3/P5
ADM40-24Z/0.24	24000	0.24	220	1.2	400	74	102	M19×1	200	64	27	1×6004VVC3/P5
												1×6002VVC3/P5
ADX51-10Z/1.8	10000	1.8	380	3.7	166	120	102	M27×2	332	131	48	2×7007C/P4
												1×6004VVC3/P5
ADX51-12Z/1.5U	12000	1.5	220	4.9	200	120	102	M25×1.5	289	94	36	2×7006C/P4
												1×6004VVC3E/P5
ADX51-18Z/2.5U	18000	2.5	220	9.4	300	120	102	M25×1.5	309	94	36	2×7006C/P4
												1×6004VVC3E/P5
ADX51-18Z/3.37	18000	3.37	380	7.1	300	120	102	M25×1.5	338	122	36	2×7006C/P4
												1×6004VVC3E/P5
ADM60-12Z/1.5	12000	1.5	380	3.5	200	120	102	M14	335	105	65	1×6205VVC3E/P5
												1×6004VVC3E/P5
MDJ14-7Z/3	7000	3	380	6.3	233	142	142	M30×2	420	157	104	2×7009C/P4
												1×6007VVC3E/P5
MDJ14-7Z/4	7000	4	380	8.3	233	142	142	M30×2	465	157	104	2×7009C/P4
												1×6007VVC3E/P5
ADM14-7Z/5.5	7000	1.5	380	12.4	233	142	142	M30×2	495	157	104	2×7009C/P4
												1×6007VVC3E/P5

### Contact Us:

#### Anyang General International Co.,Ltd

Add: Suite A, 4/F Jinhao Business Bld., Renmin Rd., Anyang, Henan, P.R.C.

Zip Code: 455000

Tel: (86) 372 5965148

Fax: (86) 372 5951936

[Http://www.gcmachines.com](http://www.gcmachines.com)

E-mail: info@agico.com.cn